



**UNITYMAX**<sup>®</sup>  
4X4 OFF-ROAD ACCESSORIES



UNITY 4WD ACCESSORIES CO.,LTD  
广州市优拓越野车用品有限公司





# 广州市优拓越野车用品有限公司

UNITY 4WD ACCESSORIES CO.,LTD

## 企业简介

### Enterprises Introduction

广州市优拓越野车用品有限公司，是一家专业生产越野车用品以及改装件的企业，产品涵盖：涉水器、电动绞盘、越野车轮毂、农夫千斤顶、顶胎器、法兰盘、车顶帐篷、车边遮阳棚、车顶灯、沙梯、越野车轮眉、放气阀、补胎工具、地锚等越野车用品。

Unity 4WD Accessories Factory is a professional manufacturer of 4wd accessories. since 2007 ,Unity 4WD has specialized in manufacturing a large range of 4WD accessories from recovery equipment to four-wheel driving touring accessories and 4x4 offroad accessories .Currently Unity 4WD is one of the main producer for Air locker ,Electric Winch, Roof top Tent, Snorkel, Wheel Spacer, Roof Rack, Recovery Kits, etc in China 4x4 accessories Field .We Welcome Customers to DO THE OEM in Our Factory.

Our commitment is “Top quality is the best policy “.We aim to provide excellent products at excellent price for excellent clients all around the world. We believe “Unity is strength” .all of UNITY 4WD staff hold together to provide you with the most enthusiastic ,professional Services.

With advanced products, good quality ,full products, perfect after service , we got a better credit and the performance of export is notable .And now 80% we have been exporting in bulk to Europe, America, Asia, and Africa. Over 65 countries and regions .Our products are highly praised by more than 180 foreign clients.

We expect a long-term and cooperative relationship with our customers . Any comment or enquiry from you will receive our careful and immediate reply. We welcome customers to visit us and contact us!

- 01 Snorkel Series  
涉水器
- 09 Fender Flare Series  
轮眉
- 12 Winch Series  
绞盘
- 13 Winch Accessories  
绞盘配件
- 17 Snatch Straps Series  
拖车带
- 19 Tow Tool Kits Series  
拖车类
- 20 Roof Top Tents Series  
帐篷
- 22 Outdoor Equipment Series  
户外用品
- 24 Jerry can Series  
油桶
- 25 Bumper Series  
保险杠
- 27 Side Step Series  
脚踏板
- 28 Roof Rack Series  
行李架
- 30 Farm Jack Series  
千斤顶
- 31 Double Shackle/Spacer/Pick up Space Arm Series  
双卸扣垫片平衡杆
- 32 Free Wheel Hub Series  
自由轮毂
- 33 Air Locker Series  
差速器
- 34 Wheel Spacer Series  
法兰盘
- 36 Refrigerators Series  
冰箱
- 37 Air Compressor Series  
气泵
- 38 Suspension Series  
底盘悬挂件
- 39 Roof Console & Roller Drawers System Series  
车顶柜抽屉
- 40 Jeep Accessories Series  
吉普配件
- 47 LED Lamp Series  
灯具
- 51 Safety Flags Series  
安全沙滩旗
- 52 SKIP PLATE  
下护板
- 53 Soft Tri-Fold Cover (PVC)  
软三折尾箱盖
- 54 Roll-Up Cover (PVC)  
软卷尾箱盖



## UNI-STFJCRS



Toyota-FJ CRUISER SS410HF  
TOYOTA FJ CRUISER 1GRFE  
4.0Litre-V6  
Material :LLDPE

## UNI-STLC40B



TOYOTA LANDCRUISER 40  
Year: 1/80 to 12/84  
2H 4.0Litre-I6 Diesel  
2F 4.2Litre-I6 petrol / 3B  
3.4Litre-I4 DieselMaterial :LLDPE

## UNI-STLC60



TOYOTA LANDCRUISER 60,61,62series  
LANDCRUISER 1/80 to 12/89  
2F 4.2Litre-I6 P RHS  
3F 4.0Litre-I6 P RHS  
2H 4.0Litre-I6 D RHS  
12H-T 4.0Litre-I6 D RHS

## UNI-STLC70



TOYOTA LANDCRUISER 71,  
73,75,78 & 79 series  
Narrow Front  
Year:1/85 to 3/07  
Material: LLDPE

## UNI-STLC75



TOYOTA LANDCRUISER 75 SS75HF  
TOYOTA LANDCRUISER HJ /FJ 75;2H  
DIESEL(4.0L) 3F PETROL(3.4L)  
Material :LLDPE

## UNI-STLC76



TOYOTA LANDCRUISER  
71,73,75,78,79  
WIDE FROM LANDCRUISER  
Diesel 1HZ 4.2Litre-I6  
Diesel 1VD-FTV 4.5Litre-V8  
Intercooled Turbo  
Material :LLDPE

## UNI-STLC78



TOYOTA LANDCRUISER 78 SS78HFZ  
HZJ 75/78 SERIES 4.2 DIESEL  
(1HZ ENGINE)  
MATERIAL :LLDPE

## UNI-STLC80



TOYOTA LANDCRUISER 80  
SERIES(ALL MODELS)  
MATERIAL :LLDPE

## UNI-STPR90P



TOYOTA LANDCRUISER LC90  
PARODO 3.4L V6 PETROL  
(5VZ-FE ENGINE).  
MATERIAL :LLDPE

## UNI-STPR90D



TOYOTA PRODO 90  
Year: 12/97 to 12/02  
1KZ-TE 3.0Litre-I4 Disel Left  
Hand Side  
Material :LLDPE

## UNI-STLC100



TOYOTA LANDCRUISER 100 SERIES  
(1HZ,1FZFE,2UZFE)  
MATERIAL :LLDPE

## UNI-STLC105 Toyota 100



TOYOTA Landcruiser / Lexus LX  
470 4/98 to 9/07 1FZ-FE 4.5Litre-I6  
Petrol 2UZFE V8 4.7Litre-V8 Petrol  
1HZ 4.2Litre-I6 Disel  
1HD-FTE 4.2Litre-I6 Disel  
Material :LLDPE



# 越野车涉水器系列 4x4 Snorkel Series



## UNI-STPR120A



Toyota-LC120 SS186HF/ SS186HF  
TOYOTA LANDCRUISER PRADO 120  
SERIES, 4.0L V6(1GR-FE ENGINE)  
1KD-FTV 3.0Litre-I4 /  
1KZ-TE 3.0Litre-I4  
Material :LLDPE

## UNI-STPR150A



Toyota Prado150Series:SS189HF/SS188HF  
10/09 onwards 1GR-FE 4.0Litre-  
V6 Petrol; 10/09 onwards  
1KD-FTV 3.0Litre-I4 D RHS

## UNI-STLC200



Toyota-LC200 SS87HF  
Toyota PRADO  
200SERIES:1VD-FTV  
4.5Litre-V8 Intercooled  
Twin Turbo/2UZ-FE. 4.7Litre-V8 DOHC.  
Material :LLDPE

## UNI-STH65



TOYOTA HILUX 65 Series  
Year: 1/83 to 12/88  
4Y 2.2Litre-I4 P LHS  
3Y 2.0Litre-I4 P LHS  
2L 2.4Litre-I4 D LHS  
MATERIAL:LLDPE

## UNI-STH105



TOYOTA HILUX 105  
22R 2.4 Litre-L4 petrol ,left side  
Material :LLDPE (not include  
two pcs Alloy castings)

## UNI-STH106



TOYOTA HILUX 106  
3L 2.8Litre-I4 Diesel ,left side  
Material :LLDPE (not include two  
pcs Alloy castings)

## UNI-STH167L



TOYOTA HILUX 167  
5L 3.0Litre-I4  
Diesel 1KZ-TE 3.0Litre-I4 Diesel  
5L-E 3.0Litre-I4 Diesel  
Left Hand Side Material :LLDPE

## UNI-STH167R



TOYOTA HILUX 167  
5VZ-FE 3.4Litre-V6  
P RHS 3VZ-E 3.0Litre-V6 P  
RHS 3RZ-FE 2.7Litre-I4  
P RHS 3L 2.8Litre-I4 D RHS  
Material :LLDPE

## UNI-STH125



TOYOTA HILUX VIGO  
2005 MODEL  
4.0L VVT-i V6 Petrol  
(1GR-FE Engine)  
Material :LLDPE

## UNI-STH120



TOYOTA HILUX VIGO  
2005 MODEL  
3.0L D4D TDI (1KD-FTV Engine)  
Material :LLDPE

## UNI-STHR15



Toyota-Hilux Revo Snorkel  
(Thailand Style )TOYOTA HILUX  
Revo(ALL) 2015 MODEL 2.7L  
2692CC164Cu. In. I4 GAS DOHC  
Naturally Aspirated  
Material :LLDPE

## UNI-STHR15A



Toyota-Hilux Revo  
Snorkel ( Australia Style )TOYOTA  
HILUX Revo (ALL) 2015 MODEL  
2.7L 2692CC 164Cu. In. I4 GAS DOHC  
Naturally Aspirated  
Material :LLDPE

## UNI-STTCMA



Toyota-Tacoma Snorkel  
SS171HP2005-2015 Toyota  
Tacoma Snorkel (SS171HP)

## UNI-STTCMB



Toyota-Tacoma Snorkel  
SS172HP2016+ Toyota  
Tacoma Snorkel (SS172HP)

## UNI-SNY60A



Nissan-Y60 SS10HF-VPCNISSAN  
GQ PATROL Y60(NISSAN PATROL /  
FORDMAVERICK TD-42 DIESEL  
(4.2L) 1990-94; TB-42PETROL (4.2L);  
ALL RB-30PETROL (3.0L)  
Material :LLDPE

## UNI-SNY60B



Nissan-Y60B Snorkel  
SS13HF-HPC  
Nissan Patrol GQ(Y60)  
Diesel TD42 Horizontal Pre-clearer  
4.2Litre-I6 Diesel TD42 Vertical  
pre-clearer Material:LLDPE

## UNI-SNY61A



Nissan-Y61A SS15HF  
NISSAN GU PATROL Y61  
TB45E, TB48E, RD28ETi & TD42  
Material :LLDPE

## UNI-SNY61B



Nissan-Y61B SS16HF  
1/03 to 8/04  
TD42-TI/ZD30DDTI/TD42-T/ZD30DDTI  
4.2Litre-I6/ 3.0Litre-I4/  
Material :LLDPE

## UNI-SNY61C



Nissan-Y61C SS17HF 9/04 onwards  
TD42-TI/ZD30DDT  
4.2Litre-I6 /3.0Litre-I4  
Material:LLDPE

## UNI-SNY61D



Nissan GU PATROL Y61D  
TB48E 9/04 on  
Material :LLDPE

## UNI-SNND21A



Nissan Navara  
D21 Snorkel  
SS700HF

## UNI-SNND40A



Nissan-D40 SS730HF  
NISSAN D40 NAVARA/R51  
PATHFINDER-2.5L YD25DDT  
ENGINE Material :LLDPE

## UNI-SNND40B



Nissan-D40 Snorkel SS731HF  
Nissan-D40 ST/STX 2010  
OnwardsSpain Built Vin  
No: VSK2.5Litre-I4Disel  
\*Does not suit  
RX 4x2and 4x4 models

## UNI-SNND22A



Nissan Navara D22 Snorkel  
SS720HF Nissan Navara  
D22/ Frontier 01/1997-10/2001  
Diesel QD32 , 3.2litre-T4 .



# 越野车涉水器系列 4x4 Snorkel Series



## UNI-SNND725



Nissan Navara D22  
A.1/07 Onwards (Single Battery Only),  
YD25DDTi 2.5Litre-I4 diesel B.10/01  
to 12/06 ZD30DDT 3.0Litre-I4  
diesel Material :LLDPE

## UNI-SNNP300A



Nissan-NP300 Snorkel  
SS740HF ( Australia model )  
Snorkel Nissan Navara NP300 D23  
ST/ST-X Dual Cab 2.3L Diesel

## UNI-SNY160



Nissan-Y160A  
SS11HF Nissan Y160A  
MQ/MK(SD33 3.3LITRE-L6,SD33-R  
3.3LITRE-L6) LEFT SIDE  
Material :LLDPE

## UNI-SML047



Mitsubishi Pajero  
NA Series(L047)1/83 to  
12/89(4D56-T/4D56)2.5Litre-I4  
Material :LLDPE

## UNI-SMV31



mitsubishi pajero V31  
NH-NJ4D56 DIESEL(2.5L)4D56  
TURBO DIESEL(2.5L) 4G54  
PETROL (2.6L) 6G72 PETROL  
(3.0L)1/90 to 7/97 Material :LLDPE

## UNI-SMV6



Mitsubishi Pajero Shogun  
1991-1999 V33 / V6  
MATERIAL: LLDPE

## UNI-SMV73



Mitsubishi V73A  
(6G74 3.5LITRE-V6,4M41-T  
3.2LITRE-L4)  
Material :LLDPE

## UNI-SMDL400



MITSUBISHI Delica L400  
1994-2006 -Petrol  
and Diesel  
MATERIAL:LLDPE

## UNI-SMT650



Mitsubishi Triton MK Series  
10/96 to 10/06  
4M40-T 2.8Litre-I4 D RHS  
4M40 2.8Litre-I4 D RHS  
Material :LLDPE

## UNI-SMT660



Mitsubishi Triton MN/ML Series  
10/06 onwards 4M41-T  
3.2Litre-I4 Material :LLDPE  
EXCEPT Models fitted with HID  
Headlamps Come with water tank

## UNI-SMT662



Mitsubishi Triton 15+  
snorkelSS662HFMitsubishi  
Triton MQ 2.4L Diesel

## UNI-SMT665



Mitsubishi-Sport  
06-Snorkel SS665HF

## UNI-SJYJ



Jeep-Wrangler YJ Snorkel  
JEEP WRANGLER YJ ( 4.0L E.F.I)  
Material :LLDPE YJ: 1986-1996  
TJ:1997-2006 JK:2007-2017  
JL: 2018~

## UNI-SJTJ



Jeep Wrangler TJ  
10/1992 to 10/2006  
Petrol AMC16 4.0Litre/I6  
Material :LLDPE

## UNI-SJJK



Jeep Wrangler JK  
Eghv6 3.8Litre-v6, right  
hand drive ,Vehicle  
Fitment Only  
Material :LLDPE

## UNI-SJXJ



JEEP Cherokee XJ 4.0L E.F.I  
PRE JAN 1995  
Material :LLDPE

## UNI-SJZJ



JEEP Grand Cherokee ZJ1/93-12/98  
MagnumV8 5.9Litre-V8 P LHS  
Magnum V8 5.2Litre-V8 P LHS  
AMC16 93-95 model requires relocation of PCM and additional installation steps.  
4.0Litre-I6 P LHS  
Material :LLDPE

## UNI-SLR350A



Land rover- Discovery 1  
-Snorkel Engine:TD300  
SE Energy:2.5litre  
Fuel:Diesel type Left side

## UNI-SLR390A



Land rover- Discovery 1  
Snorkel Discovery 300 series/  
Discovery 1

## UNI-SLRD2



Land rover Discovery 2-ss395hf  
1999 onwards:TD5 turbo intercooled 5  
cyl. 2.5 litre , V8 3.9/4.0 litre  
Petrol Left Hand Side  
Material :LLDPE

## UNI-SLRD3



Land Rover-Discover 3 Snorkel  
(TDV6 SE 2.7LITRE, Diesel, Right side)  
Material :LLDPE

## UNI-SLRD4



Land rover Discovery 4 (TDV6 SE 2.7LITRE, Diesel, /  
3.0 TDV6 (Twin Turbo), 3.0 litre ,  
Right side) Material :LLDPE

## UNI-SLRD4NA



Land rover Discovery 4 (TDV6 SE 2.7LITRE, Diesel, /  
3.0 TDV6 (Twin Turbo), 3.0 litre ,  
Right side) Material :LLDPE

## UNI-SLRDFL



Land Rover Defender Snorkel  
SS500R LAND ROVER Defender 2.5L  
T.D.I Model N° SS500R  
(left side) Material :LLDPE



# 越野车涉水器系列 4x4 Snorkel Series



## UNI-SLRDF



LAND ROVER Defender TD4/ Td5  
( TD5 Turbo Intercooled 5cyl.2.5 litre,  
diesel,right side) SS575HF  
Material :LLDPE

## UNI-SLRD5A



LAND ROVER Defender TD5  
1999 onwards( TD5 Turbo  
Intercooled diesel 5cy 1.25 litre,  
l,right side)Material :LLDPE

## UNI-SIR155



ISUZU RODEO Snorkel SS155HF /  
SS150HF ISUZU RODEO  
01/ 2002 to 12/2002 R9 1/97 to 12/01  
4JB1-T / 4JX1T-E1 2.8Litre / 3.0Litre-I4  
Material:LLDPE

## UNI-SIR100



ISUZU RODEO / CAMPO  
R7 1/88 to 12/96  
4JB1T 2.8Litre-I4 D LHS

## UNI-SIJ200



ISUZU JACKAROO / TROOPER /  
Monterey SS225HF/SS200HF/  
SS250HF

## UNI-SIDM165



ISUZU D-MAX 2009 Onwards  
(Does not suit 4x2 SX Models)  
4JJ1-Hi-Power(3.0Litre-I4)  
Material :LLDPE

## UNI-SIDM12A



ISUZU D-MAX Snorkel (TJM design)  
06/ 2012 Onwards  
Material :LLDPE

## UNI-SIDM12B



ISUZU D-MAX Snorkel (Safari design)  
06/ 2012 Onwards  
Material :LLDPE

## UNI-SS810



SUZUKI SIERRA / SAMURAI /  
GYPSY Snorkel  
SS810HF

## UNI-SSJN



SUZUKI Jimny Snorkel  
SUZUKI SIERRA / SAMURAI /  
GYPSY 1/84 - 12/97 G13A  
1.3 Litre-I4 P RHS  
Material :LLDPE

## UNI-SSJNB

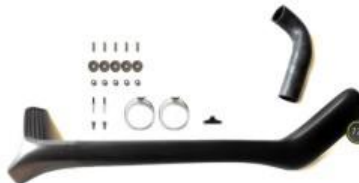

SUZUKI Jimny Snorkel  
Suzuki Jimny Year: 1997-2011.3L  
Petrol 4WD 4x4 Material :LLDPE

## UNI-SGVTA



Suzuki GRAND VITARA (right side)  
1996 to 2006  
NOTE: THIS MODEL WITHOUT  
TEMPLATE

## UNI-SMBT50A



Mazda Bravo BT50  
1/07 - 2011  
3.0Litre-I4 Diesel  
Material :LLDPE

## UNI-SMBT50B



azda Bravo BT50  
3.2Litre-5Cyl  
Diesel08/11 OnwardsRight  
hand side

## UNI-SFR07



Ford Ranger  
Year: 12/06 to 07/11  
3.0L-I4 Diesel  
Material :LLDPE

## UNI-SFR11A



FORD RANGER  
08/11 OnwardsPX All ModelsP4AT  
2.2Litre-I4 ; P5AT 3.2Litre-I5Diesel ,  
right hand side

## UNI-SFR11B



FORD RANGER  
08/11 OnwardsPX All ModelsP4AT  
2.2Litre-I4 ; P5AT 3.2Litre-I5Diesel ,  
right hand side

## UNI-SFR16A



Ford Ranger T7 2016onwards2.2L  
2198CC 134Cu.In. I4 DIESEL DOHC  
Turbocharged2.5L 2488CC 152Cu.  
In. I4 GAS DOHC NaturallyAspirated3.2L  
195Cu. In.I5 DIESEL DOHC Turbo charged

## UNI-SHTRC



Hyundai Terracan Snorkel  
Turbo Diesel Only  
Material :LLDPE

## UNI-SVA03



Volkswagen Amarok03/11-onwards  
TD1400 Twin Turbo Intercooled  
Diesel 2.0 Litre 4Cyl

## UNI-SGMH3A



GM/Isuzu H3 Hummer Snorkel

## UNI-SYA3A



Russia CarYaz-0469/ UAS  
HunterEngine: 2.7  
Material :LLDPE

## UNI-SUAV



SYAZNA  
Russia Car UAZ PatriotRussia  
CarUAZ PatriotEngine:2.7  
Material :LLDPE

## UNI-SNIVA21A



SNIVA21A Russia carLada Niva  
Engine: 1.6-1.7 Material :LLDPE



# 越野车涉水器系列 4x4 Snorkel Series



UNI-SCLR12



Chevrolet COLORADO snorkel  
Chevrolet COLORADO 05/12  
Onwards 2.8 Litre - I4 Diesel  
Material : LLDPE

UNI-ST4RN



Toyota-4Runner Snorkel,  
2010-2018

SH-S



77mm snorkel head

SH-B



85mm snorkel head

PC-77 / PC-85



77mm pre-cleaner  
85mm pre-cleaner

PC-77B / PC-85B



77mm pre-cleaner 12inch Cup  
85mm pre-cleaner 12inch Cup

SMH-77 / SMH-85



77mm Sahara mushroom head  
85mm Sahara mushroom head

SMH-S / SMH-B



77mm mushroom head  
85mm mushroom head

SMH-1 / SMH-2



77mm mushroom head  
85mm mushroom head

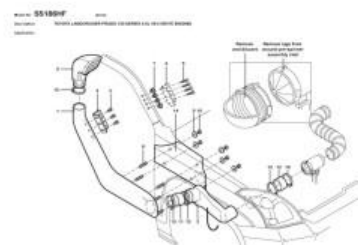

FF-VIGO-05



Toyota Hilux Vigo  
2005-2010  
fender flare (6pcs/set)

FF-V4D12B



TOYOTA HILUX VIGOfender flares  
2012-2014  
ABS material

FF-THR15B



Toyota Hilux Revo 2016 on  
FENDER FLARE (6pcs/set)

FF-THR15C



Toyota Hilux Revo 2016  
onFENDER FLARE (6pcs/set)

FF-TFTN15B



TOYOTA FORTUNER 2015  
ONFENDER FLARE

FF-FE15B



FORD EVEREST 2015-2017  
Pocket Rivet Style  
FENDER FLARES

FF-FR12A



FORD RANGER 2012 fender  
flarePS MATERIAL

FF-FR12B



FORD RANGER T6 2012-2014  
Pocket Rivet Style  
FENDER FLARES

FF-FR15B



FORD RANGER T7  
2015 -2017 Pocket Rivet Style  
FENDER FLARES

FF-DMAX07



ISUZU DMAX  
Fender flare  
08-12 YEAR(6pcs/set)

FF-DMUX14A



ISUZU MUX  
FENDER FLARES  
2014-2017

FF-DM12B



ISUZU D-MAX  
FENDER FLARES  
2012-2017



FF-BT5014



MAZDA BT50 2012  
FENDER FLARES(6pcs/set)

FF-VA10



VW AMAROK 2010-ON  
Fender flare,PS Material

UNI-JFFA



SUZUKI Jimny 10/1998+  
Material:ABS

FF-TRITON



Mitsubishi Triton 06  
(L200)Fender flare (4pcs/set)

FF-TT06B



Mitsubishi Triton  
2006 Fender Flares

FF-TDRFF14



2014 YOTOTA TUNDRA  
fender flare,Material:ABS



3 metre roll



FRF-25mm	Flex Rubber Flares 25mm	The flexible rubber flare mounts from underneath the wheel arch, it can be attached using tech screws or bolts. To obtain a more rigid and flatter shape just insert 4mm wire through the hole in the outer edge of the rubber. The wire can be bent to help maintain the wheel arch shape. Long : 3 meter/pc (for two tires)
FRF-35mm	Flex Rubber Flares 35mm	
FRF-43mm	Flex Rubber Flares 43mm	
FRF-65mm	Flex Rubber Flares 65mm	

FF-NN4D05A



NISSAN NAVARA/frontier2005-2012  
4 doors FENDER FLARES

FF-TDRFF07



TOYOTA TUNDRA 2007-2013  
FENDER FLARES

FF-F15015



Ford F-150 2015-2017  
FENDER FLARES

FF-F15008



Ford F-150  
2008-2014 FENDER FLARES

FF-DR1500



DODGE RAM 1500 fender  
flare, Material: ABS

FF-TCM14



TOYOTA TACOMA  
2014-2017 FENDER FLARES

FF-FJ



Toyota FJ Cruiser 2007-2015  
Material: ABS (6pcs/set)

FF-SR1500



SIERRA 1500 fender  
flare, Material: ABS

UNI-FS4



Jeep wrangler JK 07-14  
Material: ABS

FF-TJ



Jeep Wrangler TJ Fender Flares  
Material: ABS

FF-XJ



Jeep XJ Fender Flares  
Material: ABS

UNI-FF-FS3



Jeep wrangler JK 07-14  
Material: ABS



# 越野车绞盘系列 4x4 Electric Winch Series



EW3500	3500lbs Steel Rope ATV Electric Winch
EW3500I	3500lbs +Synthetic ROPE ATV Electric Winch



Ew4500	4500lbs Steel Rope ATV Electric Winch
EW4500I	4500lbs +Synthetic ROPE ATV Electric Winch



EW6000N	6000lbs Steel Rope Electric Winch
EWR6000N	6000lbs Synthetic Rope Electric Winch



Ew8000N	8000lbs Steel Rope Electric Winch
EWR8000N	8000lbs Synthetic ROPE Electric Winch



EW9500N	9500lbs Steel Rope Electric Winch
EWR9500N	9500lbs Synthetic Rope Electric Winch



Ew12000N	12000lbs Steel Rope Electric Winch
EWR12000N	12000lbs Synthetic ROPE Electric Winch



EW10000XT	10000lbs Steel Rope Electric Winch
EW10000XTS	10000lbs Synthetic Rope Electric Winch
EW12000XT	12000lbs Synthetic Rope Electric Winch
EW12000XTS	12000lbs Synthetic Rope Electric Winch



EW15000XT	15000lbs Steel Rope Electric Winch
EW15000XTS	15000lbs Synthetic Rope Electric Winch



EW17000XT	17000lbs Steel Rope Electric Winch
EW17000XTS	17000lbs Synthetic Rope Electric Winch

QC-50A



50A quick connector

QC-175A



175A quick connector

BIS-N



Battery Isolation Switch

F-R-B



Fairlead Roller Material : Steel

A-F-1 / A-F-2 / A-F-3 / A-F-4



Aluminium Alloy  
Plating / spraypaint

R-B



Recovery Blocks

L-P-F1



Winch License Plate  
for Steel Fairlead

L-P-F2



Winch License Plate  
for Steel Fairlead

L-P-F3



winch license plate  
for Aluminium fairlead

OR-1



450A Output relay

OR-2



200A Output relay

CBOX



Winch Control Box



WRC-1



Wireless Remote Controller

WRC-2



Wireless Remote Controller

G-A-2



Ground Anchor-Black color

WH-1/4;WH-5/16;WH-3/8



Winch Hook

BS209-4



Rated capacity 8T



WTH-1



Winch tow hook

WTH-2



Winch tow hook

WAK-B



Carry bag

WTH-5



Flatlink Shackle Mount

W-T



Factor 55 ProLink Loaded

SB-9T



Snatch Block 9000

SB-4T



Snatch Block 4T

SB-8T



Snatch Block 8T

SB-10T



Snatch Block 10T

WCD



Winch Cable Dampener

W-C



winch cover

HL



hammerlock

WRP-1



Winch Rubber Protector

UNI-SP1



Shackle Protector

H-R-3



Winch Mounting Receiver

SS1035

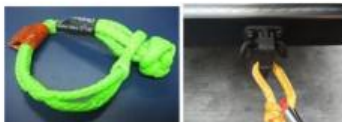

SS1035	10mmx35cm Synthetic Shackle
SS1050	10mmx50cm Synthetic Shackle
SS1063	10mmx63cm Synthetic Shackle

BS210-1



BS210-1	5/8 "U" Bow shackle
BS210-2	3/4 "U" Bow shackle

BS209-1



BS209	15/8 "D" Bow shackle
BS209	23/4 "D" Bow shackle
BS209	37/8 "D" Bow shackle



TKS-2



- Custom Recovery Kits 8pcs
1. a carry bag.
  2. a large snatch block 8T,
  3. a Leather gloves
  4. a Tree Trunk Protectors 80mmx3m
  5. a Winch Extension Straps 55mmX20m
  6. a Snatch Straps 7.5cm x 7metre
  7. 2pcs 3/4 "D" Bow shackle,

TKS-3



- Premium Recovery Kits 9pcs
1. 1 carry bag.
  2. 1 Snatch Block 9000,
  3. 1 Leather gloves
  4. 1 Tree Trunk Protectors 80mmx5m
  5. 1 Winch Extension Straps 80mmX20m,
  6. 1 Snatch Straps 10cm x 7metre
  7. 2pcs 3/4 "D" Bow shackle,
  8. 1 winch cable dampener

L-G



Leather gloves

M-P-1



Winch Mounting plate

M-P-2



Winch Mounting plate

UNI-LPB01



License Lamp Plate  
Stainless steel

UNI-LPB02



License Lamp Plate  
Aluminium

## Tree Trunk Protectors



TTP-8003	Size:80mmx3m, breaking capacity:12000kgs, with 7% elongation
TTP-8005	Size:80mmx5m, breaking capacity:12000kgs, with 7% elongation

## Winch Extension Straps



WES-5520	55mmX20m ,breaking capacity:6800kgs with 7% elongation Reinforced eyes
WES-8020	80mmX20m ,breaking capacity:12000kgs with 7% elongation Reinforced eyes Eye&

## Snatch Straps



SS-7509	breaking capacity:8000kg, Size:75mm x 9m, with 20% elongation
SS-1009	breaking capacity:12000kg, Size:100mm x 9m, with 20% elongation

## kinetic snatch straps



KSS1/2	Size:1/2" x 15', breaking capacity:7,400 lb with 30% elongation
KSS3/4	Size:3/4" x 30', breaking capacity:19,000 lb. with 30% elongation
KSS1	Size:1" x 30', breaking capacity:33,500 lb. with 30% elongation
KSS1-1/4	Size:1-1/4" x 30', breaking capacity:52,300 lb. with 30% elongation
KSS1-1/2	Size:1-1/2" x 30', breaking capacity: 74,000 lb. with 30% elongation

## NEW kinetic snatch straps



KR1306	Size:13mm(1/2')x6m, breaking capacity:8,370lbs with 30% elongation
KR1909	Size:19mm (3/4')x9m, breaking capacity:18,060 lbs with 30% elongation
KR2409	Size: 24mm(1')x9m, breaking capacity:27,900lbs with 30% elongation
KR3209	Size:32mm(1-1/4')x9m , breaking capacity:48,020 lbs with 30% elongation
KR3809	Size:38mm(1-1/2')x9m , breaking capacity:61700lbs with 30% elongation

## Strap Carry Bag



KRCB-1	Carry bag For 3/4"-1" Kinetic Rope
KRCB-2	Carry bag For 1-1/4" Kinetic Rope
KRCB-3	Carry bag For 1-1/2" Kinetic Rope





# 越野车拖车类系列 4x4 Tow Tool Kits Series



## Synthetic rope



S-R-1	Size: 8x30M / Material: <b>Dyneema SK75</b> made in Netherlands / Breaking capacity:5500kgs
S-R-2	Size: 9.5x30M / Material: <b>Dyneema SK75</b> made in Netherlands / Breaking capacity:7500kgs
S-R-3	Size: 10x30M / Material: <b>Dyneema SK75</b> made in Netherlands / Breaking capacity:9500kgs
S-R-4	Size: 12x30M / Material: <b>Dyneema SK75</b> made in Netherlands / Breaking capacity:16500kgs
S-R-5	Size: 14x30M / Material: <b>Dyneema SK75</b> made in Netherlands / Breaking capacity:22000kgs

## Synthetic rope



color and other size are available for choose

UNI-SR004	Size: 4mm Material:UHMPE/ Breaking capacity:1800kgs
UNI-SR005	Size: 5mm Material:UHMPE / Breaking capacity:3000kgs
UNI-SR006	Size: 6mm Material:UHMPE/ Breaking capacity:4000kgs
UNI-SR007	Size: 7mm Material:UHMPE / Breaking capacity:5200kgs
UNI-SR008	Size: 8mm Material:UHMPE/ Breaking capacity:6800kgs
UNI-SR009	Size: 9mm Material:UHMPE/ Breaking capacity:8500kgs
UNI-SR0095	Size: 9.5mm Material:UHMPE / Breaking capacity:9400kgs
UNI-SR010	Size: 10mm Material:UHMPE / Breaking capacity:10500kgs
UNI-SR011	Size: 11mm Material:UHMPE / Breaking capacity:11800kgs
UNI-SR012	Size: 12mm Material:UHMPE / Breaking capacity:13500kgs Size: 14mm
UNI-SR014	Size: 14mm Material:UHMPE / Breaking capacity:19050kgs
UNI-SR016	Size: 16mm Material:UHMPE / Breaking capacity:25378kgs

## Synthetic shackle



Shackle-1	10mmx35cm Material:UHMPE Breaking capacity:14700kgs Other size available
Shackle-2	10mmx50cm Material:UHMPE Breaking capacity:14700kgs Other size available
Shackle-3	10mmx63cm Material:UHMPE Breaking capacity:14700kgs Other size available



**B-M-2B /3B**



Ball Mount  
2 inch,black center  
core :1.015" (2.58CM)  
3 inch,black center  
core:1.015"(2.58CM)

**T-C**



2"x3" 3500LBS  
1-7/8"x2-1/2" 2000LBS  
1-7/8"x2" 2000LBS

**H-B**



2" X1"X2-1/8"  
6000LBS  
1-7/8"X1"X2-1/8"  
2000LBS

**BS-4**



Tow bar  
Universal

**PURH**



Pick up rope hook

**R-H**



Tow hook

**PAH-1**



Pin and Hitch

**PAH-2**



Hitch locker

**RCV**



Receiver

**UNI-RWE**



receiver with ears

**T-H-1**



Tow Hook-B  
Black Color

**T-H-2**



universal , capacity : 5t  
Material: ZG45

**T-H-3**



universal , with Ball ,  
capacity : 8t  
Material: ZG45

**T-H-4**



universal , with Ball ,  
capacity : 8t  
Material: ZG45

**T-H-5**



universal , with Ball ,  
capacity : 8t  
Material: ZG45

**T-H-6**



Universal , with Ball ,  
capacity : 8t  
Material: ZG45

**T-H-7**



universal , with Ball ,  
capacity : 8t  
Material: 304  
stainless steel

**T-H-8**



universal , with Ball ,  
capacity : 8t  
Material: ZG45

**T-H-10**



long model  
universal , with Ball ,  
capacity : 8t  
Material: ZG45

**T-H-11**



Short model universal , with  
Ball , capacity 8t  
Material: ZG45:

**T-H-14**



universal , with Ball ,  
capacity : 8t  
Material: ZG45  
Without Hitch locker



# 越野车帐篷系列 4x4 Outdoor Equipment Series



## RTT-1 帐篷



Oxford/(280g polyester-cotton)  
color: green and beige )  
6cm thickness high quality cushion  
Unfolding Size: 240\*143\*126CM  
Packing Size: 150\*125\*30CM  
Inner size:233\*140\*123cm  
ladder:2.3m

## RTT-2



Oxford/(200g polyester-cotton)  
(same as ARB material )  
6cm thickness high quality cushion  
Unfolding Size: 240\*143\*126CM  
Packing Size: 150\*125\*30CM  
Inner size:233\*140\*123cm  
Ladder:2.0m

## RTT-3



RTT-1 with back awning  
AWNING:120cm\*140cm\*195cm

## RTT-4



RTT-2 with back awning  
AWNING:190cm\*140cm\*195cm

## RTT-5



Oxford/(280g polyester-cotton)  
(color: green and beige)  
6cm thickness high quality cushion as  
picture  
Unfolding Size:310\* 143\*126  
CM  
Packing Size: 150\*125\*30CM  
Inner size:300\*140\*123cm  
Ladder:2.3m  
with back awning

## RTT-6



Oxford/(280g polyester-cotton)  
(color: green and beige) 6cm thickness  
high quality cushion  
Unfolding  
Size: 240\*143\*126CM  
Packing  
Size: 150\*125\*30CM  
Inner  
size:233\*140\*123cm  
Ladder:2.3m

## RTT-7



Oxford/(280g polyester-cotton)  
(color: green and beige)  
6cm thickness high quality cushion  
Unfolding  
Size: 240\*143\*126CM  
Packing  
Size: 150\*125\*30CM  
Inner  
size:233\*140\*123cm  
Ladder:2.3m

## RTT-8



Polygon Tent Room (price is only  
for the wall)  
Material: 200D polyester  
2.5\*2.5m  
carton: 32x23x60cm/1pc  
GW: 11KGS

## RTT-9



Mosquito Net for AW-1 awning  
(Height: 210cm to 220cm)

## CS-1



Camping Swags-1

## CS-2



Camping Swags-2

## Aw-3



Awning :fabric size 1800x2800mm

## FAW-2020



FAW-2020	Foxwing Awning 2m * 2m
FAW-2525	Foxwing Awning 2.5m * 2.5m

## FAR-2020



FAR-2020	Foxwing awning Room 2m * 2m
FAR-2525	Foxwing awning Room 2.5m * 2.5m

## EF-3020



EF-3020	Extension Fabric 3m * 2m
EF-2020	Extension Fabric 2m * 2m
EF-2520	Extension Fabric 2.5m * 2m

## M-N-2020



M-N-2020	Mosquito Net fit 200*200cm awning
M-N-2520	Mosquito Net fit 250*200 awning
M-N-2525	Mosquito Net fit 250*250cm awning
M-N-2530	Mosquito Net fit 250*300 awning

## AWR-2020



AWR-2020	Awning wall room fit 200*200 cm awning
AWR-2520	Awning wall room fit 250*200cm awning
SAWR-2525	Awning wall room fit 250*250cm awning
AWR-2530	Awning wall room fit 250*300 awning

## Aw-1520



Aw-1520	Awning-150*200cm
Aw-1525	Awning-150*250cm
Aw-2020	Awning-200*200cm
Aw-2025	Awning-200*250cm
Aw-2030	Awning-200*300cm
Aw-2520	Awning-250*200cm
Aw-2525	Awning-250*250cm
Aw-2530	Awning-250*300cm
Aw-3025	Awning-300*250cm
Aw-3030	Awning-300*300cm

## T-L-1



Tent ladder 2.3M tent ladder adjustable, aluminum

## LED120-WH

### LED Camping Light DUAL COLOUR! White & Amber



LED120-WH	Awning LED Light Kit (white)
LED120-WHAM	Awning LED Light Kit (white and Amber)
LEDS-WH	Awning LED Light Kit (Aluminium)



# OUTDOOR EQUIPMENT



S-T



**Sand Track**  
 1. Rubber Traction for recovery from Sand, Mud, Dirt and Snow.  
 2. Measuring 1500mm x 300mm

SL-OP-2



**SAND LADDER**  
 1122x34.5x5 cm, capacity 4Ton ,3.5KGS ( Price for one Pair )

SL-OP-4



**SAND LADDER**  
 capacity: 5T108x33x6.5cm  
 weight: 6KGS/PAIR price is for one pair

BR



**Bath room**  
 120\*120\*190CM Material :190T

BR-N



SS



shower set

SBB-20



Solar bath bag, 20L

SBB-40



Solar bath bag, 40L

4-1-K



4 IN 1 Knife Knife / Saw / Axe / bottle opener

4-1-K



4 IN 1 Knife Knife / Saw / Axe / bottle opener

SV-1



spare wheel shovel / stainless steel

SV-2



[ size ] : Unfold:40.5cm  
 width:10cm

SV-3



[ size ] : Unfold:47cm  
 width:11cm

SV-4



[ size ] : Unfold:60cm  
 width:15cm

**BK**



size :23\*10cm  
volum :9L

**MOS-1**



Multifunctional Shovel-1  
20 kinds of function!!!

**T-A**



Table : 86\*68\* 68(high) cm  
Chair :29.5\*19.5\*40.5 (high)cm  
Material:Aluminium material

**T-W**



Table : 86\*68\* 68(high) cm  
Chair :29.5\*19.5\*40.5 (high)cm  
Material:Wood material

**RT-306**



Biding yarn 20MM\*6M  
breaking capacity:1.5 ton

**RK**



peedy Seal Puncture Repair Kit

**TD**



Tire Deflator

**W-B-8**



water bag-10L

**C-TW**



[ 10pcs size ] :4CM\*10CM  
1PCS size ] :11CM \*11CM  
Price for 10pcs towel/set

**CONVERSION TABLE**

PSI	KPA(approx)
5	34.5
10	69
15	103.5
20	135
25	172.5
30	207
35	241.5
40	276
45	310.5
50	345
55	379
60	413.5

1 PSI = 0.06895 KPA

**VALVE STEM ADAPTOR**  
SCREWS UNT ON TO VALVE STEM

**VALVE CORE REMOVER**  
SCREW CLOCKWISE TO INSERT  
VALVE CORE OR ANTI-CLOCKWISE  
TO REMOVE VALVE CORE

**INTERNAL THREAD**  
SCREWS OV TO VALVE STEM

**SLIDE VALVE**  
PUSH FORWARD TO HOLD/READ  
PHESSUHE  
PULL BACK TO BLEED AIR

## T-G Tire Gauge

the E-Z Deflator allows for removal of the valve core for rapid tyre deflation, while also providing accurate pressure reading via the simple movement of a sliding valve.



# JERRY CAN



UNI-E20: 20Litre  
UNI-E10: 10Litre  
UNI-E5: 5Litre



JCUE-5L



JCUE-10L



JCUE-20L

\*Material: DC4 Cold-roll steel sheet  
\*Wall thickness: 0.8mm  
\*Different Color for choose  
\*Power coated



JCE-5L  
JCE-10L  
JCE-20L



JCU-5L  
JCU-10L  
JCU-20L



JCS-5L



JCS-10L



JCS-20L

\*Material: stainless steel #304  
\*Includes one plastic oil spout  
\*Thickness: 0.8mm



FS  
Flexi Spout (USA)



STB-1  
HOLDER Bracket



JCH-1  
Jerry can holder



Front Bumper- A



Front Bumper- B



Front Bumper- C



Front Bumper-D



Front Bumper- E



Front Bumper- F



Front Bumper- G



Front Bumper- H



Rear Bumper- A



Rear Bumper- B



Rear Bumper- C



Rear Bumper- D

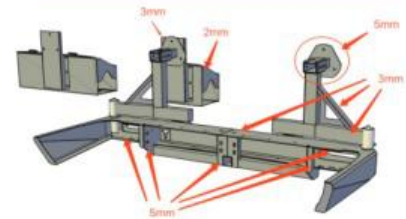

UNI-REVO-FB/RB	Toyota Hilux Revo 2015+	UNI-FRT6-FB/RB	Ford Ranger 2012+(T6)
UNI-HV05-FB/RB	Toyota Hilux VIGO 2005-2011	UNI-FRT7-FB/RB	Ford Ranger 2015 + (T7)
UNI-HV12-FB/RB	Toyota Hilux VIGO 2012-2015	UNI-FEVR-FB/RB	Ford Everest 2015 +
UNI-LC76-FB/RB	Toyota Land Cruiser 76 Series	UNI-NP300-FB/RB	Nissan Navara NP300 2015+
UNI-LC77-FB/RB	Toyota Land Cruiser 77 Series	UNI-D40-FB/RB	Nissan Navara D40 (06-11)
UNI-LC80-FB/RB	Toyota Land Cruiser 80 Series	UNI-Y60-FB/RB	Nissan Patrol Y60
UNI-LC90-FB/RB	Toyota Land Cruiser Prado 90 Series	UNI-Y61-FB/RB	Nissan Patrol Y61
UNI-LC100-FB/RB	Toyota Land Cruiser 100 Series	UNI-Y62-FB/RB	Nissan Patrol Y62
UNI-LC120-FB/RB	Toyota Land Cruiser Prado 120 Series	UNI-TT06-FB/RB	Mitsubishi Triton 15+
UNI-LC150-FB/RB	Toyota Land Cruiser Prado 150 Series	UNI-TT15-FB/RB	Mitsubishi Triton (06-14)
UNI-LC200-FB/RB	Toyota Land Cruiser 200 Series	UNI-CLR-FB/RB	Chevy Colorado (2012)
UNI- FJ-FB/RB	Toyota FJ Cruiser Series	UNI- JGC14-FB/RB	Jeep Grand Cherokee 2014
UNI- FTN-FB/RB	Toyota Fortuner 2008-2011 Series	UNI- V31-FB/RB	Mitsubishi Pajero V31
UNI-DMAX07-FB/RB	Isuzu D-max (07-11)	UNI- V93-FB/RB	Mitsubishi Pajero V93/V97
UNI-DMAX12-FB/RB	Isuzu D-max 2012+	UNI-UAZ-FB/RB	Russia UAZ
UNI-MUX-FB/RB	Isuzu MUX 2012+	UNI-LD-FB/RB	Russia Lada Niva



# 越野车保险杠系列 4x4 Bumper Series



UNI-3844



TOYOTA HILUX VIGO-05-08  
WITH LAMP & STONE GUARD  
Front Bumper

UNI-3855



TOYOTA HILUX VIGO-05-08  
WITH LAMP & STONE GUARD  
Front Bumper

UNI-1213FA/3999



TOYOTA HILUX VIGO-2012-2014  
WITH LAMP & STONE GUARD  
Front Bumper

UNI-3076



TOYOTA FJ 80 Front Bumper

UNI-3842



TOYOTA PRADO FJ 120-2003  
WITH LAMP & STONE GUARD

UNI-3794 A



TOYOTA FJ CRUISER Front Bumper

UNI-3493



TOYOTA FJ CRUISER Front  
Bumper

UNI-2718A



TOYOTA FJ CRUISER Rear Bumper

UNI-2718B



TOYOTA FJ CRUISER Rear Bumper

UNI-Y60-FD



NISSAN PATROL Y60 Front  
Bumper

UNI-Y60-RA



NISSAN PATROL Y60 Rear Bumper

UNI-3964



NISSAN PATROL Y61 (2005-present)  
Front Bumper

UNI-SSVA



Volkswagen AMAROK  
Side Step

UNI-SSTV12



TOYOTA VIGO Side Step

UNI-SSFR12-1



FORD RANGER Side Step

UNI-SSNGU123



Nissan Y61 GU1-3 Side Step

UNI-SSNGU4



Nissan Y61 GU4 Side Step

UNI-SSND22



Nissan D22 Side Step

UNI-SSLC80



TOYOTA FJ80 Side Step

UNI-SSLC100



TOYOTA FJ100 Side Step

UNI-SSLC105



TOYOTA FJ105 Side Step

UNI-TOYOTA



FJ120 Side Step

UNI-SSLC150



TOYOTA FJ150 Side Step

UNI-SSLC200



TOYOTA LC200 Side Step



# 越野车行李架系列 4x4 Roof Rack



RR-2A



4x4 Roof Rack 50"x39"

RR-3A



4x4 Roof Rack 50"x39"

RRS-1/RRA-1



6117 Roof Rack  
Steel or Aluminium  
125/180/220x125

RRS-2



6114 Roof Rack  
Steel or Aluminium  
125/180/220x125

RRS-3



6113 Roof Rack  
Steel or Aluminium  
125/180/220x125

RRS-4



6116 Roof Rack  
Steel or Aluminium  
125/180/220x125

RRS-5/RRA-5



6115 Roof Rack  
Steel or Aluminium  
125/180/220x125

RRS-6



RRS-TV	Toyota Hilux VIGO 2005-17 Special Laser Bracket
RRA-TV	Toyota Hilux VIGO 2005-17 Special Laser Bracket
RRS-MT	Mitsubishi Triton 2006-17 Special Laser Bracket
RRA-MT	Mitsubishi Triton 2006-17 Special Laser Bracket
RRS-IDMX	ISUZU DMAX 2012+ Special Laser Bracket
RRA-IDMX	ISUZU DMAX 2012+ Special Laser Bracket
RRS-RNG	Ford Ranger 2012-17 T6/T7 Special Laser Bracket
RRA-RNG	Ford Ranger 2012-17 T6/T7 Special Laser Bracket
RRS-NVR	NISSAN NAVARA D40 / NP300 Special Laser Bracket
RRA-NVR	NISSAN NAVARA D40 / NP300 Special Laser Bracket

RRS-7/RRA-7



6022 Roof Rack  
Steel or Aluminium  
125/180/220x125

RRS-8/RRA-8



6024 Q2 Roof Rack  
Steel or Aluminium  
125/180/220x125

RRS-9/RRA-9



6142 Roof Rack  
Steel or Aluminium  
125/180/220x125

RRS-10



2.2x1.25m Roof Rack  
Steel or Aluminium  
125/180/220x125

## Laser Bracket Roof Rack



Toyota LC100	LEXUS LX470
Toyota LC120	Land Rover Discovery 3/4
Toyota LC150	Jeep Grand Cherokee
Toyota LC200	HYUNDA TERRACAN
Toyota Fotuner	Nissan Patrol Y62
Toyota FJ Cruiser	Mitsubishi Pajero Sport

## Toyota FJ Cruiser



RRS-FJ-180	180x125
RRA-FJ-180	
RRS-FJ-220	220x125
RRA-FJ-220	

## JB XWA3/JB XWA4

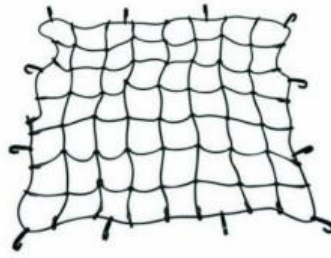

4x4 CargoNet  
size :130x110cm  
size :160x110cm

## RRM-1



Roof rack mount  
USE For Farm Jack installation on  
Roof Rack  
For ARB roof rack or

## M-B



Mounting Bracket for Jerry Can ,  
only for Unity Roof racks

## RRM-2



Roof rack mount  
USE For Farm Jack installation on  
Roof Rack  
For UNITY roof rack

## RB-S



Rack Bag  
Size:1100 x 800 x 460mm

## Roof rack bracket



15CM/20CM/25CM/29CM

## Sand Ladder Bracket





# 越野车千斤顶系列 4x4 Farm Jack Series



FJ-48, 48" Farm Jack FJ-60, 60" Farm Jack



With 7000lbs capacity  
CE CERTIFICATE

B-L



Bumper Lift has a  
3,000lb, (1361 kg)  
capacity.

L-M-1



Lift-mate, Material: Manganese  
Steel ,Tetoron, Nylon Size:  
11\*12\*8.5cm, Weight: 2kg.

ORC



Off-Road Base,ABS, 32x32x10cm

FJM-1



Farm Jack Mount,Aluminium material

FJM-2



Farm Jack Mount,Steel material

JP-48 / JP-60



Hi-Lift Jack Protector

RRM-1 / RRM-2



RRM-1 / RRM-2

FJM-3



lift jack tube mount -2" -3" adjustable  
aluminum material

HK



Handle-Keeper





- UNI-BPV05: TOYOTA HILUX VIGO 05-14
- UNI-BPR15: TOYOTA HILUX REVO 2015+
- UNI-BPD07: ISUZU D-MAX 07-11
- UNI-BPD12: ISUZU D-MAX 2012+
- UNI-BPS12: CHEVROLET COLORADO 2012+
- UNI-BPF12: FORD RANGER T6 2012+
- UNI-BPM12: MAZADA BT50 2012+
- UNI-BPT06: MITSUBISHI TRITON 12-14
- UNI-BPT15: MITSUBISHI TRITON 2015+
- UNI-BPN08: NISSAN NAVARA D40
- UNI-BPC15: NISSAN NAVARA NP300 2015+

- Read Instruction Manual
- Installation By Foreman
- Use Proper Tools
- Use Recycle

## 4x4 Double Shackle Installation Manual

Follow the installation instructions:

<p>1</p> <p>Check The Contents Box</p>	<p>2</p> <p>Use The Correct Lift Up Mechine</p>	<p>3</p> <p>Check The OEM Parts</p>
<p>4</p> <p>Left</p>	<p>Right</p>	<p>5</p> <p>Reconfirm The A, B &amp; C Position</p>

**Remark : After installation please ensure all the bolts & nuts are tightened before test drive the vehicle.**



- Anti-shack
- Heavy duty bush
- High tensile bolt
- 8mm thickness material
- Reduces responding force
- Good efficient on normal driving & off road
- Easy to install
- Maintenance free
- Powder coat finishing



### Suitable Car Model:

- Toyota Hilux VIGO 05-15
- Toyota Hilux REVO 15+
- Mitsubishi Triton 06-14
- Mitsubishi Triton 15+
- Nissan Navara D40
- Nissan NP300
- Ford Ranger 12+
- Isuzu D-MAX07-12
- Isuzu D-MAX12+



# 越野车自由轮毂系列 4x4 Free Wheel Hub Series



Serial Number	Car Model
B001	free wheel hub 43530-69065 TOYOTA Landcruiser PRADO V8 / Spline:30
B002	free wheel hub 43530-60042 TOYOTA Landcruiser 4500CC, pickup 1976-85 / Spline:30
B003	free wheel hub 43530-69045 TOYOTA FJ Cruiser 1960-70 / Spline:28
B004	free wheel hub 43530-60130 TOYOTA Land Cruiser FJ100 / Spline:30
B005	free wheel hub 40350-39045 TOYOTA 4WD pickup, 4 Runner, 79-85 / Spline:26
B006	free wheel hub 43509-35030 TOYOTA Hi-Lux, HIACE, 86-96 / Spline:26
B007	free wheel hub 43508-35050 TOYOTA 4 Runner, Hi-Lux / Spline:26
B008	free wheel hub TOYOTA Landcruiser 63-75, Bandeirantes 60-82 / Spline:6
B009	free wheel hub TOYOTA Hi Lux, 4Runner, LN/RN, T100, 86-96 / Spline:26
B010	free wheel hub 43508/09-36011 TOYOTA Truck / Spline:34
B011	free wheel hub MD886389 MITSUBISHI Pajero Triton, L200 4x4, Montero, 1990-2000 / Spline:28
B012	free wheel hub MITSUBISHI Pajero, Triton, L200 4x4, Montero, 90-00 / Spline:28
B013	free wheel hub 40250-01J01 NISSAN Patrol, Safari GQ, GU, 1990-up / Spline:31
B014	free wheel hub 40250-2S610 NISSAN Pickup Pathfinder, Navara D21, 1990-up / Spline:28
B015	free wheel hub 40250-32G10 NISSAN Pickup Pathfinder, Navara D21, Terrano 1986-89 / Spline:27
B016	free wheel hub 40250-20J01 NISSAN Safari GQ Y60 / Spline:31
B017	free wheel hub 40250-VB200 NISSAN Safari GU Y61 / Spline:31
B018	free wheel hub 40260-1S700 NISSAN Pickup D22, X-Terra / Spline:28
B019	free wheel hub NISSAN Pathfinder H.B, 4 x 4 PU, 80-87 / Spline:27
B020	free wheel hub NISSAN Pathfinder, Xterra, 4 x 4 PU, 90-up / Spline:28
B021	free wheel hub NISSAN Patrol, 4 x 4 PU, 90-up / Spline:31
B022	free wheel hub 8-97113446-PT ISUZU Pickup, Trooper, 1987-92 / Spline:17
B024	free wheel hub 8-97032-905 ISUZU Truck / Spline:20
B025	free wheel hub F3TZ3B396B FORD Bronco II/Ranger/Explorer, 83-89 / Spline:23
B026	free wheel hub F3TZ3B396B Ford Explorer, 90-94 Ford Ranger, 90-97 Mazda pickup, 94-97 Mazda Navajo, 90-94 / Spline:27

Serial Number	Car Model
B027	free wheel hub Ford Bronco, 86-89 Ford F100/F150, 12 Ton pickup, 84-91 Ford F250/F350 pickup, 89-91 Chevy Suburban/Blazer/Impala 88-91 Chevy 12 Ton pickup, 88-91 / Spline:19
B028	free wheel hub SUZUKI Sidekick/Geo Tracker, all kinds of manual hub / Spline:26
B029	*SUZUKI Geo Tracker, Sidekick, X-90, Vitara, Escudo, 89-01, JIMNY, SJ 410, SJ 413, Samurai, Sierra / Spline:26*
B030	SUZUKI Sidekick/Geo Tracker / Spline:26
B031	JEEP, Station Pick Up, Jeepster C101 Commando, Gladiator, Wagoneer, Pick Up, Cherokee, Scout / Spline:10
B032	JEEP CJ Universal, Jeepster C104, Scout II, Terra, Traveller / Spline:27
B033	*JEEP, CJ Universal, Scrambler 81-86 / Spline:27*
B034	*KIA Sportage, Grand Sportage, Retona, Frontrier, Besta 4X4 Bongo AVM 460 Spline:26*
B035	SSANGYONG Korando II, Musso SUV, Rexton/TD, Musso Pick Up AVM 450, Spline:28
B036	DODGE Dodge Power WC50 & 60, WM 300 WC 56, 57, 59 & M 3781 Spline:16 AVM 408
B037	GAZ UAZ 61---> Spline:10
B038	*MAZDA B series, Fighter 99-01 FORD Ranger INT'L ONLY 99-01 Courier--->90, Spline:26*
B039	43810-60A00 free wheel hub SUZUKI X-90, Vitara, Escudo, 89-01, JIMNY, SJ 410, SJ 413, Samurai, Sierra
B040	free wheel hub Malaysia TOYOTA truck ; Spline:34
B041	free wheel hub Mitsubishi Fuso Canter FG Truck 4x4 ; 1996-2004 Spline:34
B042	AVM 423 free wheel hub NISSAN Patrol MK/MQ/P40, 80-89 AVM 423
B043	40250-01J0A free wheel hub NISSAN Safari GQ Y60 (automatic)
B044	AVM 432 free wheel hub ISUZU Jackaroo, Trooper I and II 83-86 AVM 432
B045	AVM 424 free wheel hub NISSAN Pick Up 720, 72-82 AVM 424
B046	40250-C6000 free wheel hub NISSAN Patrol MK/MQ/P40, 80-89
B047	free wheel hub DAIHATSU Rocky, Rugged(All) 78--->
B048	AVM421/521 free wheel hub TOYOTA Land Cruiser 76-87 Hi Lux (all exc A30), Pick Up, 76-88 Bandeirantes, 83-91 Land Cruiser 4200, FJ 7075, 88-89 4Runner, --->8686
B049	free wheel hub Jeep CJ Universal 72-80 Scout II, Terra, Traveller, 71-80 Jeepster C104, 72-73 Engesa, 85-84
B050	free wheel hub NISSAN Patrol MK/MQ 80-89



**Air Locker Including - Replacement differential, activation switch, solenoid valve, air line and bulkhead fittings,air compressor**



**Fit for the car model as below :**

	<p>"LC78,79,100,105,40,55,60,62,75,80,120,prado,LJ70,RJ70,Hilux, Pick up,4runner,LN61,YN63,ect."</p>
	<p>Frontier,Xterra,Navara,pick up, D21,Wagon,Pathfinder,Y61,Y60,Terrano,Wagon</p>
	<p>Montero,Raider,Pajero,Delia,Challenger,Montero sport,Triton, Pick up,4ylinder,6cylinder ect</p>
	<p>Range rover,Discovery,Defender</p>
	<p>Cj(5,6,7,8),YJ ,TJ,XJ,ZJ,WJ.</p>
	<p>Sierra/samurai/jimny, Holden Drover Naranti Gypsy, Vitara, Sidekick</p>
	<p>Chevrolet/GMC/Hummer/ Dodge/Holgen/Isuzu</p>



# 越野车法兰盘 轮毂系列 4x4 Wheel Spacer



Size	PCD	Max offset		CB	Venthole	
15x7	5-139.7	10	-35	111	8spoke	
	6-139.7	10	-35	111	8spoke	
	5-114.3	10	-35	84	8spoke	
	6-139.7	18	-15	108.7	8spoke	
	6-170	18	-15	133.3	8spoke	
	5-139.7	18	-15	108.5	modular&rivet	
	5-114.3	18	-15	75	8modular	
	6-139.7	18	-15	108.7	8spoke	
	5-114.3	18	-15	84	8spoke	
15x8	5-114.3	10	-50	84	8spoke	
	5-139.7	35	-30	108.5	modular&rivet	
	6-139.7	35	-30	110	8spoke	
	5-139.7	35	-30	110	8spoke	
	5-114.3	35	-25	83.7	8spoke	
	6-139.7	35	-30	111	8spoke	
	5-139.7	35	-30	108	10D-window	
16x8	5-139.7	35	-30	108	5spoke&rivet	
	5-139.7	35	-30	108.7	8spoke	
15x10	5-139.7	40	-44	111	8spoke	
	6-139.7	40	-44	111	8spoke	
	5-114.3	40	-44	84	8spoke	
	5-139.7	60	-44	108.5	modular&rivet	
	6-139.7	60	-44	110	8spoke	
	8-165.1	0	-44	125	8spoke	
	5-139.7	20	-50	111	8spoke	
	6-139.7	20	-50	111	8spoke	
	5-139.7	35	-30	110	10 D-window	
	5-139.7	35	-30	110	10modular&rivet	
	5-150	25	-40	113	8spoke	
	5-165.1	50	-20	124	10modular	
	6-139.7	35	-30	108.7	8spoke	
	6-139.7	35	-30	108.7	D-window	
	6-139.7	35	-30	108.7	modular&rivet	
	6-139.7	35	-30	110	8spoke	
	16x10	5-139.7	40	-70	111	8spoke
		6-139.7	40	-70	111	8spoke
5-150		40	-70	114	8modular	
5-139.7		55	-60	110	10modular&rivet	



Model	THICKNESS	FROM	TO	CB	THREAD
WS-01	30mm	5x114.3	5x114.3	71.6mm	1/2
WS-02	38mm	5x139.7	5x139.7	108.4mm	12x1.25
WS-03	30mm	5x150	5x150	110mm	14x1.5
WS-04	30mm	5x165.1	5x165.1	125mm	16x1.5
WS-05	38mm	6x139.7	6x139.7	110 mm	12x1.5
WS-06	38mm	6x139.7	6x139.7	110 mm	12x1.25
WS-07	38mm	6X114.3	6X114.3	71.6mm	12x1.25
WS-08	30mm	5x127.3	5x127	71.5mm	1/2-20
WS-09	25mm	4x100	4x100	54mm	12x1.5

## KILOTON FORGING WHEEL SPACER



**THE REALLY STRONG WHEEL SPACER**

**—UNITY 4WD**



# 冰箱系列 Refrigerators Series



UNI20SL-IA,20Litre



UNI30SL-IB,30Litre



Uni45C4,45Litre



Uni55C4,55Litre



Uni60C4,60Litre



Uni80C4,80Litre



Uni70AC4/Uni90AC4



TB-F



AD-A



Uni-116



4x4 Air Compressor

Uni-118



4x4 Air Compressor

Uni-119



4x4 Air Compressor

UNI-AC002



4x4 Air Compressor

UNI-127



4x4 Air Compressor

UNI-10215



4x4 Air Compressor

UNI-AC004



4x4 Air Compressor

UNI-AC005



4x4 Air Compressor

UNI-AC006



4x4 Air Compressor

UNI-AC008



4x4 Air Compressor

UNI-102-5G



4x4 Air Compressor

UNI-102-6G



4x4 Air Compressor



# 4X4 SUSPENSION



## TOYOTA

- LC80 Suspension
- LC90 Suspension
- LC100 Suspension
- LC120 Suspension
- LC150 Suspension
- LC200 Suspension

## MITSUBISHI

- Pajero V31 Suspension
- Pajero V43 Suspension
- Pajero V73/v93 Suspension

## Nissan

- Petrol Y60 Suspension
- Petrol Y61 Suspension
- D22 Suspension

## Jeep

- Wrangler JK Suspension
- Grand Cherokee Suspension
- XJ Cherokee Suspension



Rc200	R/CONSOLE 200 SERIES GX, GXL WAGON (NOT SAHARA) 12/07...ON
RC10003GXL	R/CONSOLE 100 SERIES GXL 8/02-11/07
RC10098	R/CONSOLE 100 SERIES STD 04/98-11/07 & GXL 4/98-7/02
RC80GXL95	R/CONSOLE 80 SERIES GXL DIESEL WAGON 1995-1998
RC80ST95	R/CONSOLE 80 SERIES STANDARD WAGON 1995-1998
RC80GXL90	R/CONSOLE 80 SERIES GXL DIESEL WAGON 1990-1994
RC80ST90	R/CONSOLE 80 SERIES STANDARD WAGON 1990-1994
RC70AB	R/CONSOLE 76 WAGON *W/SRS 2009...ON , 70 SERIES DOUBLE CAB 8/12...ON
RC76	R/CONSOLE 76 WAGON *NON SRS 2007-2009
RC79CC	R/CONSOLE 79 SERIES CAB CHASSIS 1999...ON
RCPR03	R/CONSOLE PRADO 120 SERIES WAGON 2003-2009
RCPR96	R/CONSOLE PRADO 90 SERIES WAGON 1996-2002
RCFJ	R/CONSOLE FJ LANDCRUISER WAGON ( WITH NO CRAWL CONTROL IN ROOF) 2009-12/12
RCHI05	R/CONSOLE HILUX EXTRA CAB & DUAL CAB- 3/05...ON
RCHI05CC	R/CONSOLE HILUX SINGLE CAB & CAB CHASSIS- 3/05...ON
RCHI97	R/CONSOLE HILUX DUAL CAB & EXTRA CAB 11/97- 02/05
RCGU	R/CONSOLE NISSAN GU PATROL WAGON- 11/97...ON
RCGUCC	R/CONSOLE NISSAN GU PATROL SINGLE CAB/CAB CHASSIS- 2/99...ON
RCGQ	R/CONSOLE NISSAN GQ PATROL WAGON & SWB 1988-10/97
RCNAV06	R/CONSOLE NAVARA D40 DUAL CAB & KING CAB - 2005...ON
RCNAV97	R/CONSOLE NAVARA D22 DUAL CAB- 1997...ON
RCMA12	R/CONSOLE FORD RANGER PX & MAZDA BT-50 DUAL CAB - 10/11...ON
RCMA12EC	R/CONSOLE FORD RANGER PX & MAZDA BT-50 EXTRA CAB- 10/11...ON
RCMA12CC	R/CONSOLE FORD RANGER PX & MAZDA BT-50 CAB CHASSIS 10/11...ON
RCMA07	R/CONSOLE FORD PK RANGER DUAL CAB- 06-9/11 MAZDA BT50 DUAL CAB- 2006-9/11
RCMA07EC	R/CONSOLE FORD PK RANGER / MAZDA BT50 EXTRA CAB- 2006-9/11
RCCOL12	R/CONSOLE COLORADO RG DUAL CAB & EXTRA CAB 7/12...ON
RCCOL12CC	R/CONSOLE COLORADO RG SINGLE CAB 7/12...ON
RCDMAX12	R/CONSOLE ISUZU TF DMAX DUAL CAB & EXTRA CAB 7/12...ON
RCDMAX12CC	R/CONSOLE ISUZU TF DMAX SINGLE CAB 7/12...ON
RCRO03	R/CONSOLE RODEO/COLORADO/D-MAX/GREAT WALL V240 DUAL CAB- 2003-7/12
RCPAJ	R/CONSOLE MITUBISHI PAJERO NS & NT 2005...ON
RCTR06	R/CONSOLE MITUBISHI TRITON ML/MN DUAL CAB- 2006...ON
RCDEF02	R/CONSOLE LANDROVER DEFENDER WAGON- 2002...ON



	UNI-FF-FS3	Front and rear fender for jeep wrangler jk 07-14		UNI-FF-FS4	Front and rear fender for jeep wrangler jk 07-14
	UNI-FB-ED4	Front bumper for jeep wrangler jk 07+ 1. With modular topper grille 2. With "D" hook 3. With two pcs LED lights 4. Winch bumper 5. Textured black steel 6. Caton package		UNI-FB-HC1	Front bumper for jeep wrangler jk 07+ 1. With modular topper bar 2. With "D" hook 3. Winch bumper 4. Textured black steel 5. Caton package"
	UNI-FB-SC1	Front bumper for jeep wrangler jk 07+ 1. With modular topper bar 2. Winch bumper with "D" hook 3. With s/s plate on sides 4. Textured black steel 5. Caton package"		UNI-FB-SO1	Front bumper for jeep wrangler jk 07+ 1. With topper bars 2. Winch bumper with "D" hook 3. Textured black steel 4. Caton package"
	UNI-FB-CS1	Front bumper for jeep wrangler jk 07+ 1. With topper bar 2. Winch bumper with "D" hook 3. Textured black steel 4. Caton package"		UNI-FB-CS2	Front bumper with lights for jeep wrangler jk 07+ 1. With topper bar 2. With 4pcs led lights 3. Winch bumper with "D" hook 4. Textured black steel 5. Caton package
	UNI-RBT-SX1	Rear bumper with spare tire carrier for jeep wrangler jk 07+ 1. With adjustable tire mount 2. With toggle clamp and protect accessories 3. With limiting position protection 4. With rear hitch and "D" hook 5. Textured black steel 6. Caton package(two catons)"		UNI-RB-TT1	Rear bumper for jeep wrangler jk 07+ 1. With "D" hook 2. With rear hitch 3. Textured black steel 4. Caton package
	UNI-SB-DT2	"2 tubes side bar for jeep wrangler jk 07+ (2 door) 1. With 2 tubes design 2. Side armor features a dual system for under side protection 3. Textured black steel 4. Caton package"		UNI-RB-TT1	UNI-SB-DT4*2 tubes side bar for jeep wrangler jk 07+ (4 door) 1. With 2 tubes design 2. Side armor features a dual system for under side protection 3. Textured black steel 4. Caton package
	UNI-SB-TT2	3 tubes side bar for jeep wrangler jk 07+ (2 door) 1. With 3 tubes design 2. Side armor features a dual system for under side protection 3. Textured black steel 4. Caton package"		UNI-SB-TT4	3 tubes sidebar for jeep wrangler jk 07+(4 door) 1. With 3 tubes design 2. Side armor features a dual system for under side protection 3. Textured black steel 4. Caton package"

	UNI-CB-HB1	Rear cargo basket with hi-jack bracket for rear bumper with tire carrier of jeep wranglerUsed with tire carrier for jeep wrangler(rear bumper)		UNI-JR-2D	Jamboree rack for jeep wrangler jk 07-14 (2door)
	UNI-TC-MD1	Oversize tire carrier for jeep wrangler jk 07+ 1. Using the existing holes 2. Completely adjustable 3. Textured black steel 4. Caton package		JY-JE-081	TF stern door stronger bracket (Tire Carrier)
	UNI-OP-TS1	JK oil pan/transmission & convertor skid		UNI-JM-OC1	Off road jack mount for jeep wrangler jk 07+ 1. Using the existing holes 2. Incorporates a special round cutout for padlock use 3. With quick release knob 4. Textured black steel 5. Caton package
	UNI-JK-UP1	Oil pan/transmission & convertor skid		UNI-JK-VC1	Vapor canister skid plate
	UNI-JPTB	2007-2010 JEEP PATRIOR/COMPASS		UNI-JCTB	2006-2010 JEEP COMMANDER
	UNI-SS001	steel, Wrangler Bracket Application on the windshield of the JeepSize: 91*30.5*30cm Material: Rigid Iron Weight: 3.9kg/pair		UNI-SSA01	Bar bracket for Roof and curved led light bar, Application on Bumper, Carrier of the Jeep Available Size: 0.875" / 1" / 1.25" / 1.5" / 1.75" / 1.625" / 2" / 2.5" / 3", Totally 9 sizes
	UNI-SS007	designed for the 2007, 2008, 2009, 2010, 2011, 2012, and 2013 Jeep Wrangler JK		UNI-SS008	JK 10" LED Light Bar Hood Mount



	UNI-SF009	For 20inch LED light bar		UNI-SS015	Engine Bonnet Bracket Material: Rigid Iron
	UNI-SS012	Application on the LED work light and LED Light bar, the bracket is easy to install on the bumper and the rack of the vehicle		UNI-SB03	Application on the LED work light and LED Light bar
	UNI-SSX04	LED work light bracket		UNI-SFA01	Application to the hood of the Jeep, Car, Truck, off road vehicle and other vehicles
	UNI-SSA02	Application to the hood of the Jeep, Car, Truck, off road vehicle and other vehicles		UNI-SSA03	Application to the hood of the Jeep, Car, Truck, off road vehicle and other vehicles
	UNI-SS017	Led light bracket		UNI-SS004	LED work light bracket for 16W 18W 20W, Double layer scaffold bracket
	UNI-JKFL	Light cover		UNI-JKFT	Jerry can mountSteel
	UNI-JK-JL080	Engine Cover		UNI-JK-JL113	Engine Cover

	UNI-JK-002	FRONT GRILL-1		UNI-BB-009-E	FRONT GRILL-6
	UNI-BB-009	FRONT GRILL-2		UNI-JE-143	FRONT GRILL-7
	UNI-JE-086	FRONT GRILL-3		UNI-JE-144	FRONT GRILL-8
	UNI-BB-009-D	FRONT GRILL-4		UNI-JE-145	FRONT GRILL-9
	UNI-JK-AC27	Seat handle		UNI-JK-AC05	break pedal (Left side)
	UNI-JK-AC01	Jeep JK wrangler Grab Handle		UNI-JK-AC02	Jeep JK wrangler Grab Handle
	UNI-JK-AC03	Jeep JK wrangler hand hold (2doors)		UNI-JK-AC04	Jeep JK wrangler hand hold (4doors)



	UNI-JK-AC06	Handle cover		UNI-JK-AC07	Handle cover
	UNI-JK-AC10	Bonnet guard		UNI-JK-AC28	Cowl cover
	UNI-JK-AC11	Windows visor		UNI-JK-AC12	Windows visor
	UNI-JK-AC13	Heat insulation cotton		UNI-JK-AC14	Heat insulation cotton
	UNI-JK-AC16	door hinges		UNI-JK-AC19	front bumper protector (Europe model)
	UNI-JK-AC20	Fastener cover		UNI-JK-AC21	RUGGED RIDGE fastener cover
	UNI-JK-AC22	Fastener cover		UNI-JK-AC23	fuel tank cap
	UNI-JK-AC24	bonnet Locker		UNI-JK-AC25	License Plate Bracket with Lamp

	UNI-JK-AC29-1	Floor Liner, 4 door		UNI-JK-AC29	Floor Liner, 2 door
	UNI-JKHL01	Headlight- 30W-A DOT & Emark(E13)		UNI-JKHL05	Headlight 75W
	UNI-JKHL02	Headlight -30W-B DOT & Emark(E13)		UNI-J4	Headlight - 80W
	UNI--J13	Headlight 50W -7" High/Low Beam DOT & Emark(E13)		UNI-J7	Headlight - 73W
	UNI-J15	Fog light with angel eyes 4inch led		UUNI-J9	Fog light-30W
	UNIJK-TL03	Jeep JK Wrangler Tail Lights		UNI-JRLA	Rear Lamp



	UNI-JRLB	Rear Lamp –8W		UNI-JRLC	Rear Lamp
	UNI-J11	4W (PAIR FRONT FENDER JEEP WRANGLER 07-15 SMOKED TURN SINGAL SMD LED LIGHTS)		UNI-J12	4W(2 x Clear Parking Side Maker Kit LED Lights For JK Front Fender 07-15)
	UNI-J17	LED Brake/Reverse Light For jeep 12W (145*70mm)		UNI-J20	6W LED Brake Light For jeep
	UNI-JK-JL109	A pillar switch control panel		UNI-JK-JL110	A pillar switch
	JEEP JK SEAT COVER	<p>**Fits factory and most aftermarket seats from 1976 to 2011*7 individual storage pouches* Molle/Pals design*All pouches have military grade snaps and buckles with self correcting zippers*Sold individually"</p>	<div data-bbox="821 1153 1109 1198"> <h3>TAILGATE NET</h3> </div> <div data-bbox="821 1198 1109 1444"> </div> <div data-bbox="1125 1220 1444 1377"> <p><b>Features:</b></p> <ul style="list-style-type: none"> <li>• Easy to Install</li> <li>• Increases the storage space</li> <li>• Improves Gas Mileage and Reduces Air Drag</li> <li>• Universal! Net have 6" for adjusting through the straps.</li> <li>• Fit Full Sized Trucks (61"x19") / Middle Sized Trucks (51" X 15")</li> <li>• Made from Heavy duty Industrial Reinforced Fabric PVC</li> <li>• Extra Wide Nylon edging to prevent stretching and fraying</li> <li>• All Necessary mounting Hardware included</li> <li>• Packaged well to protect product</li> </ul> </div>		



UNI-ARB96	96w LED lamp
UNI-ARB111	111w LED lamp
UNI-ARB160	160w LED lamp
UNI-ARB185	185w LED lamp

UNI-0460



60W LED LAMP

UNI-0451



51W LED LAMP

UNI-1212P



12W LED LAMP

UNI-1218P



18W LED LAMP

UNI-1918



18W LED LAMP

UNI-1042



42W LED LAMP

UNI-1748P



48W LED LAMP

UNI-0727P



27W LED LAMP

UNI-0627P



27W LED LAMP

UNI-0410Y



10W LED LAMP

UNI-16RGB08



Led Rock Light



# LED灯系列 4x4 LED Lamp



UNI-C2018	18W LED BAR	UNI-C2126	126W LED BAR
UNI-C2036	36W LED BAR	UNI-C2144	144W LED BAR
UNI-C2054	54W LED BAR	UNI-C2180	180W LED BAR
UNI-C2072	72W LED BAR	UNI-C2234	234W LED BAR
UNI-C2090	90W LED BAR	UNI-C2288	288W LED BAR
UNI-C2108	108W LED BAR	UNI-C2312	312W LED BAR



UNI-118	18W Light Bar
UNI-136	36W Light Bar
UNI-154	54W Light Bar
UNI-172	72W Light Bar
UNI-190	90W Light Bar
UNI-1108	108W Light Bar
UNI-1126	126W Light Bar
UNI-1144	114W Light Bar



UNI-BC2120X	120W LED BAR
UNI-BC2180X	180W LED BAR
UNI-BC240X	240W LED BAR
UNI-BC2880X	288W LED BAR



UNI-BCS160X	60W LED BAR
UNI-BCS1100X	100W LED BAR
UNI-BCS1140X	140W LED BAR
UNI-BCS1200X	200W LED BAR
UNI-BCS1240X	240W LED BAR



UNI-B1090X	90W LED BAR
UNI-B1120X	120W LED BAR
UNI-B1150X	150W LED BAR



UNI-BCS160X	60W LED BAR
UNI-BCS1100X	100W LED BAR
UNI-BCS1140X	140W LED BAR
UNI-BCS1200X	200W LED BAR
UNI-BCS1240X	240W LED BAR



UNI-B236	36W LED BAR
UNI-B272	72W LED BAR
UNI-B2120	120W LED BAR
UNI-B2180	180W LED BAR
UNI-B2240	240W LED BAR



UNI-2030	30W LED Bar
UNI-2050	50W LED Bar
UNI-2060	60W LED Bar
UNI-2090	90W LED Bar
UNI-20100	100W LED Bar
UNI-20120	120W LED Bar
UNI-20150	150W LED Bar
UNI-20180	180W LED Bar
UNI-20200	200W LED Bar
UNI-20210	210W LED Bar
UNI-20240	240W LED Bar
UNI-20250	250W LED Bar

**UNI-6072B**



72W

**UNI-6100B**



100W

**UNI-6100BL**



100W



UNI-2524R	2524R-4inch HID OFF ROAD LAMP
UNI-2527R	2527R-7inch HID OFF ROAD LAMP
UNI-2529R	2529R-9inch HID OFF ROAD LAMP



UNI-2524B	2524B-4inch HID OFF ROAD LAMP
UNI-2522B	2527B-7inch HID OFF ROAD LAMP
UNI-2529B	2529B-9inch HID OFF ROAD LAMP



UNI-2524Y	2524Y-4inch HID OFF ROAD LAMP
UNI-2527Y	2527Y-7inch HID OFF ROAD LAMP
UNI-2529Y	2529Y-9inch HID OFF ROAD LAMP

**UNI-3800**



3800-8inch HID OFF ROAD LAMP

**UNI-3750**



3750-7inch HID OFF ROAD LAMP

**UNI-3030**



HID Remote Control Search light

**UNI-2009**



HID Remote Control Search light

**UNI-R02**



50W Wireless remote control LED LAMP

**UNI-0175**



Torch light - 7inch



# LED灯系列 4x4 LED Lamp



## UNI-S85



85W torch light

## UNI-6100B



UNI-DT001	for one lamp
UNI-DT002	for two lamp

## UNI-6100BL



UNI-WRC01	for two lamp
UNI-WRC02	for one lamp



UNI-BE2120-5D	120W-5D LED BAR
UNI-BE2180-5D	180W-5D LED BAR
UNI-BE2240-5D	240W-5D LED BAR
UNI-BE2300-5D	300W-5D LED BAR

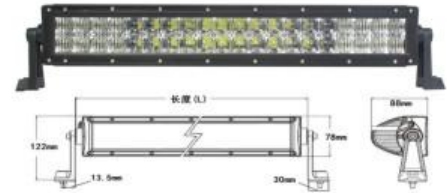

UNI-BE2120X-5D	120W-5D LED BAR
UNI-BE2180X-5D	180W-5D LED BAR
UNI-BE2240X-5D	240W-5D LED BAR
UNI-BE2300X-5D	300W-5D LED BAR



UNI-H30W	155*103*58mm 6inch
UNI-H60W	290*103*58 mm 11.5inch
UNI-H90W	425*103*58mm 16.7inch
UNI-H120W	560*103*58 mm 22inch
UNI-H150W	695*103*58mm 27inch
UNI-H180W	830*103*58mm 32.7inch
UNI-H210W	965*103*58mm 38inch
UNI-H240W	1100*103*58mm 43inch
UNI-H270W	1235*103*58mm 43inch

## Lamp cover



Color: Black, Red, Yellow, Blue, Green, Transparent  
15cm/20cm

## HEAVY DUTY SAFETY FLAGS

### Reflective flags for mining vehicles

NICAR Made quality vehicle safety flags for heavy duty environments

In developing the Vehicle Safety Flag only quality componentry has been utilised to ensure the flags are highly visible and can stand the tough conditions of the mining and industrial environment.

- ★ UV resistant materials
- ★ Gold electroplated heavy duty bases
- ★ Choice of 3 Hi-vis coloured flags
- ★ Base options include fixed or fixed with spring, quick release or quick release with spring
- ★ Off the shelf sizes range from 1m to 3.5m
- ★ 90° turn lock on quick release bases for added safety
- ★ Solid fibreglass rod
- ★ Custom building available



THE LED LIGHT COLOR BY FREE CHOICE

base and pole

with spring connect part

Pole length	pole color	type
Lc-1.2m	red or white	with led light
Lc-1.8m	red or white	with led light
Lc-2.4m	red or white	with led light
Lc-3.0m	red or white	with led light
Lc-3.8m	red or white	with led light

THE LED LIGHT COLOR BY FREE CHOICE

base and pole

with spring and quick connect part

Pole length	pole color	type
LJ-1.2m	red or white	with led light
LJ-1.8m	red or white	with led light
LJ-2.4m	red or white	with led light
LJ-3.0m	red or white	with led light
LJ-3.8m	red or white	with led light

### Instructions for connection and light part

WITH E14 SCREW BASE FOR LIGHT PART

BASE La BASE Lb BASE Lc BASE Ld

WITH BATTERY CONNECT PART

La: with spring and quick connect part  
 Lb: with quick connect part  
 Lc: with spring connect part  
 Ld: with normal connect part

WITH E14 SCREW BASE FOR LIGHT PART





# 下护板 SKIP PLATE



SP-LC150



LC150 SKIP PLATE

SP-LC200



LC200 SKIP PLATE

SP-Y62



Y62 SKIP PLATE

SP-HLRV15



SP-VG05	TOYOTA HILUX VIGO	SP-RV15	TOYOTA HILUX REVO 2015+
SP-RGT6	FORD RANGER T6	SP-RGT7	FORD RANGER T7
SP-DMX08	ISUZU DMAX 07-12	SP-DMX12	ISUZU DMAX 12-17
SP-MT06	MITSUBISHI TRITON 06-15	SP-MT15	MITSUBISHI TRITON 2015+
SP-D40	NISSAN NAVARA Np300	SP-NP300	NISSAN NAVARA Np300
SP-BT50	MAZDA BT50 2012	SP-TFTN	TOYOTA FORTUNER
SP-VOL	VOLKSWAGEN AMAROK 2010	SP-CVL	CHEVROLET COLORADO 2012



The Soft lid easy to close and open,  
Easy clamps no need tools for making the pvc plain and smooth finish look.



Tri-fold tonneau cover, No need tools of installation it.



Front Aluminum Latch



Rear Easy Clamps



OE Grade Rubber Q Seals

## Features

With tear-resistant double sided vinyl.  
6063 Grade Epoxy Coated Aluminum Frame  
OE Grade Rubber Q Seals help form a water resistant barrier,  
Terelyne Marine Grade stitching design to hold up against the harshest elements  
front flap at bulkhead to prevent leaking  
Front aluminum latch will secure the cover to the truck in extreme conditions  
Rear easy clamps mean a 5 minute installation

Snap Clip style fastening system allows for safe and easy storage in the open position.  
No need tools of installation it.

Comes completely assembled and installs in less than 5 minutes.

Low Profile Design that results in Gas Savings from 10% to 13%.

Life time:2year.

Applications for: Chevy, Ford, Dodge, Mazda, Mitsubishi, Nissan, ISUZU, Toyota

**Weight: 10-13KG**



## Roll-up cover 软卷 (PVC)



The Soft lid easy to close and open,  
Roll-up structure saving more place, Single Latch easy to management the bed.



Velcro Fastener strip

### Features

High Strength 6063 Aluminum Mounting Clamps secures the side rails to your truck for a No Drill installation.

OE Grade Rubber Seals to keep your truck bed water-tight

High Strength 6063 Aluminum Rails are epoxy powder coated to give you the durability to hold up  
Under all severe weather conditions

6063 Grade Epoxy Coated Aluminum Frame

Single Latch design helps to simplify the opening and closing of the cover.

No Drill Installation averages 25minutes

Only tools needed is a 10mm socket&ratchet

Life time:2year.

Applications for: Chevy, Ford, Dodge, Mazda, Mitsubishi, Nissan, ISUZU, Toyota

**Weight: 10-13KG**

# 广州市优拓越野车用品有限公司

UNITY 4WD ACCESSORIES CO.,LTD.



TEL:0086-20-36773611/22171859/28996644

Skype:china4x4accessories.com

Mobilephone/Wechat/Whats app:15918868099/15814848199

E-mail:manager@unity4wd.com/sales@china4x4accessories.com

Website:www.china4x4accessories.com/www.4X4order.com

广州办公室:广州市白云大道北新广从汽配城汇桥大厦3018

Office/Show Room:NO.3018,HuiQiao Building,Baiyun Dadao Bei,

Baiyun District,Guangzhou City,China;510440

广州工厂:广州市白云区石井滘心大道横岭南路大鹏工业区C栋1号

GZ Factory:Dapeng Industrial Area,Baiyun District,Guangzhou City

